

Typ / Type: **73-1-22**

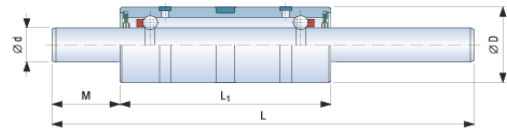

Typ / Type: **73-1-31**

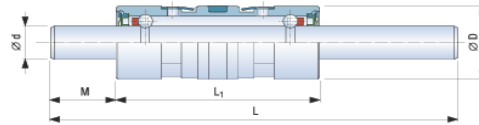

Typ / Type: **72-6**

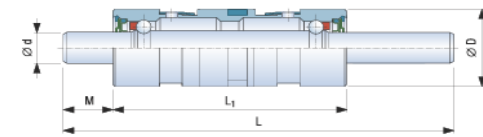

Designation	ØD	Ød	L	L ₁	M	Operating speed	Limited speed	Relubrication hole	Note
	mm					min ⁻¹	min ⁻¹		
73-1-22	22	10	112	56	18	55000	60000	Yes	
73-1-31	22	10	112	56	18	75000	80000	Yes	
72-6	22	8.9	112	61	13	85000	90000	Yes	

Typ / Type: **T 010**

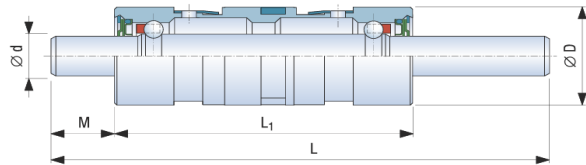

Designation	ØD	Ød	L	L ₁	M	Ceramic balls	Operating speed	Limited speed	Relubrication hole	Note
	mm						min ⁻¹	min ⁻¹		
T010	22	8.9	112	61	13	Yes	100000	105000	Yes	

Typ / Type: **T 013**

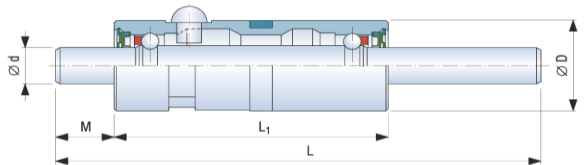

Designation	ØD	Ød	L	L ₁	M	Ceramic balls	Operating speed	Limited speed	Relubrication hole	Note
	mm						min ⁻¹	min ⁻¹		
T013	22	8.9	108	61	13	Yes	100000	105000	Yes	

Typ / Type: **76-3, 76-3KK**

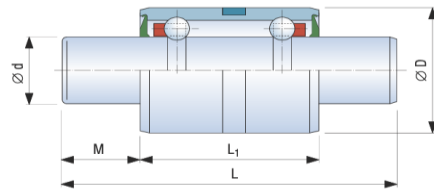

Typ / Type: **76-3-7, 76-3-7KK**

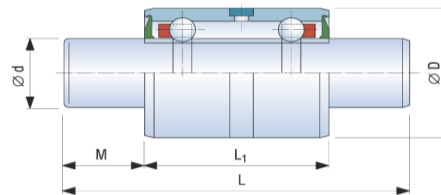

Typ / Type: **T 763**

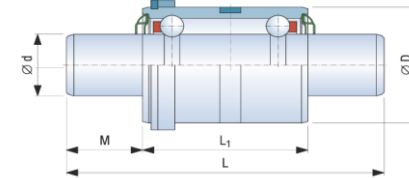

Designation	ØD	Ød	L	L ₁	M	d ₁	Operating speed	Relubrication hole	Note
	mm						min ⁻¹		
76-3	30	16	73	39	16.9	-	10000	No	
76-3KK	30	16	73	39	16.9	-	10000	No	metal seal
76-3-7	30	16	73	39	16.9	-	10000	Yes	
76-3-7KK	30	16	73	39	16.9	-	10000	Yes	metal seal
T763	30	16	73	39	16.9	-	10000	No	metal seal

Typ / Type: **73-1-28, 73-1-49**

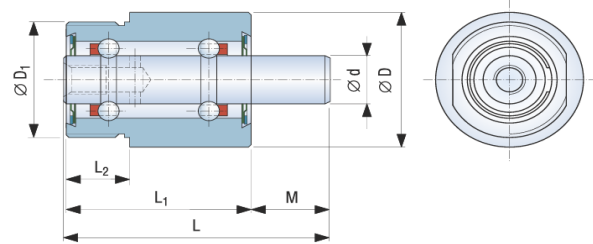

Designation	ØD	ØD ₁	Ød	L	L ₁	L ₂	M	Operating speed	Relubrication hole	Note
	mm							min ⁻¹		
73-1-28	28	M24x1	10	50.5	35	12	15	15000	No	
73-1-49	28	M24x1	10	54.5	39	16	15	15000	No	

Typ / Type: 76-3-1

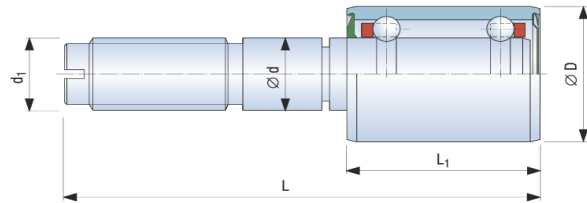

Designation	$\varnothing D$	$\varnothing d$	L	L_1	M	d_1	Operating speed min^{-1}	Relubrication hole	Note
mm									
76-3-1	30	16	96	39	-	M16x1.5	12000	No	

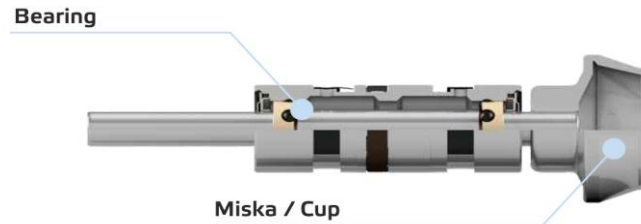

Bearing	RPM min^{-1}	Rotor Cup Type(without holes)
73-1-22	25000-45000	Z66DN
	40000-60000	Z54DN
	40000-60000	T50DN
73-1-31	55000-75000	T46DN
	55000-75000	T43DN
	60000-80000	T40DN
T010	75000-105000	T34D
	75000-105000	T34DN
	75000-105000	R34DN
T013	80000-105000	C533/U-D
	80000-105000	C533/Tr-D
	75000-95000	C536/U-D
	65000-90000	C338/U-D
	60000-90000	C341/U-D

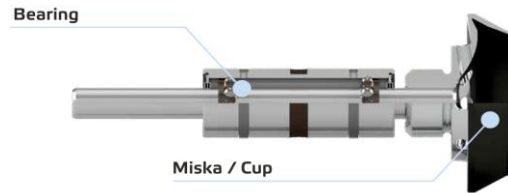

Bearing	RPM min ⁻¹	Rotor Cup Type(without holes)
73-1-22	25000-45000	E66Butterfly
	25000-45000	E66
	40000-60000	E54Butterfly
	40000-60000	E54
73-1-31	55000-75000	E43
	60000-80000	E40
72-6	55000-75000	E43
	70000-90000	E36

Typ / Type: 83-15

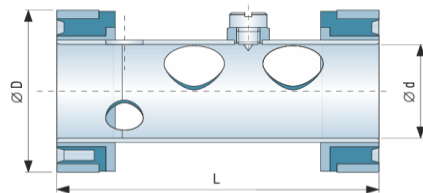

Designation	ØD	Ød	L	Application for the Bearings with the Limited Speed	Note
	mm				
83-15	38	22	70	80000	

Typ / Type: **83-18-6**

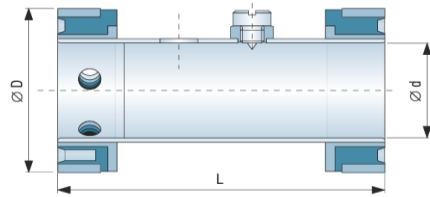

Typ / Type: **83-18-4**

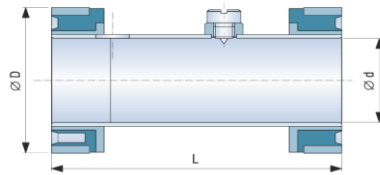

Typ / Type: **83-18-5**

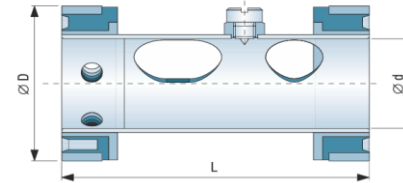

Designation	ØD	Ød	L	Application for the Bearings with the Limited Speed	Note
		mm			
83-18-6	38	22	69	115000	
83-18-4	38	22	69	90000	
83-18-5	38	22	69	105000	



2Z

2ZR



2RS

2RSR

N

NR

Series	d	D	B
6000-6034	10-170	26-260	8-42
6200-6230	10-150	30-270	9-45
6300-6321	10-105	35-225	11-49
6403-6418	17-90	62-225	17-54
16002-16030	15-150	32-225	8-24
61800-61836	10-180	19-225	5-22
61900-61930	10-150	22-210	6-28
603-609	3-9	9-24	3-7
623-629	3-9	10-26	4-8
633-637	3-7	13-19	4-6

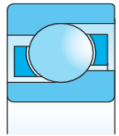

rad / series
72, 73 (TNG)

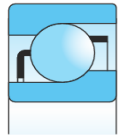

rad / series
72, 73

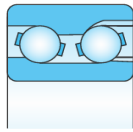

rad / series
32, 33

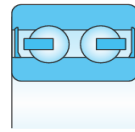

rad / series
32, 33 (2RSR, TNGH)

Series	d	D	B
7200AA-7220AA	10-100	30-180	9-34
7200B-7226B	10-130	30-230	9-40
7303AA-7316AA	17-80	47-170	14-39
7301B	12-110	37-240	12-50

Series	d	D	B
3200E-3220E	10-100	30-180	14.3
60.3			
3200-3220(2ZR,2RS)	17-80	47-170	14.3
60.3			

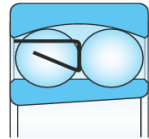
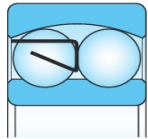

K

Series	d	D	B
1200-1220	10-100	30-180	9-34
2200-2220	10-100	30-180	14-46
1300-1320	10-100	35-215	11-52
2301-2320	12-100	37-215	17-73

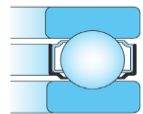

rad / series
51

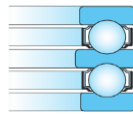

rad / series
52

Series	d	D	B
51100-51132	10-160	24-200	9-31
51200-51232	10-160	26-225	11-51
51305-51322	25-110	52-190	18-63
51405-51420	25-100	60-210	24-85
52202-52218	10-75	32-135	22-62
52405-52412	15-50	60-130	45-93
52305-52325	20-60	52-135	34-79

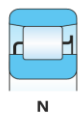

N

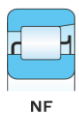

NF

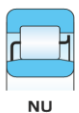

NU



NUP



R NU



NJ



HJ

Series	d	D	B
203-230	17-150	40-270	12-45
303-326	17-130	47-280	14-58
405-422	25-110	80-280	21-65
2203-2228	17-140	40-250	16-88
2304-2320	20-100	52-215	21-73
1008-1060	40-300	68-460	15-74

Typ / Type: **Jednoradové / Single-Row**



Series	d	D	B
30202A-30230A	15-150	35-270	11.75-49
30302A-30328A	15-140	42-300	14.25-67.75

31305A-31328A	25-140	62-300	18.25-77
32004AX-32032AX	20-160	42-240	15-51
32204A-32232A	20-160	47-290	19.25-84
32304A-32324A	20-120	52-260	22.25-90.50
33010A-33022A	50-110	80-170	24-47
33109A-33118A	45-90	80-150	26-45
33205A-33220A	25-100	52-180	22-63

Typ / Type: **Dvojrádové / Double-Row**



CA



CC

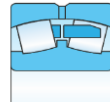

MB

Series	d	D	B
21304-21322	20-110	52-240	15-50
22205-22240	25-200	52-360	18-98
22308-22340	40-200	90-420	33-138
23022-23040	110-200	170-310	45-82
23120-23140	100-200	165-340	52-112
23218-23240	90-200	160-360	52.4-128
24020-24040	100-200	150-310	50-109
24122-24140	110-200	180-340	69-140